

INSTRUMENT HOUSING – type XD-FI

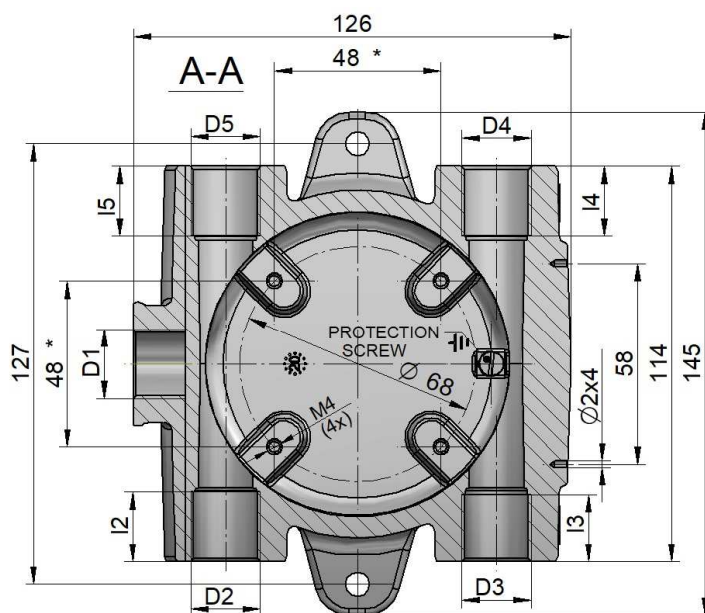

* - other dimensions possible

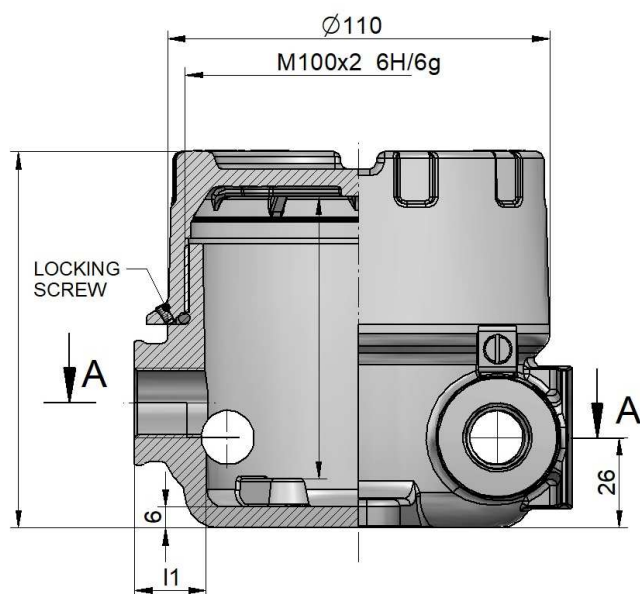
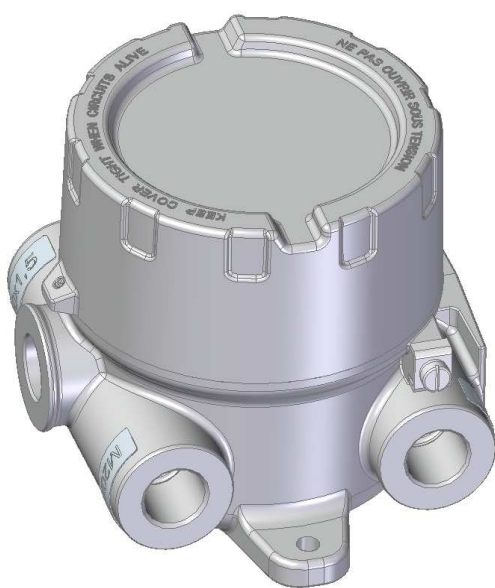

Material of body and cover: aluminium pressure die-casting



Service temperature: $T_{amb} = -40 \div 100^{\circ}\text{C}$ ($-40 \div 100^{\circ}\text{C}$ with window) – oil proof rubber

$T_{amb} = -60 \div 150^{\circ}\text{C}$ ($-50 \div 100^{\circ}\text{C}$ with window) – silicone rubber

$$T_{amb} = -20 \div 200^{\circ}\text{C} \text{ } (-20 \div 100^{\circ}\text{C} \text{ with window}) - \text{FKM rubber}$$

Coating: yellow chromating and chemically resistant paint (outside only)

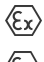
THREAD D ₅	l ₅ [mm]	THREAD D ₄	l ₄ [mm]	THREAD D ₃	l ₃ [mm]	THREAD D ₂	l ₂ [mm]	THREAD D ₁	l ₁ [mm]	SEAL MATERIAL	COATING
M20x1.5 M24x1.5 M25x1.5	20	M20x1.5 M24x1.5 M25x1.5	20	M20x1.5 M24x1.5 M25x1.5	20	M20x1.5 M24x1.5 M25x1.5	20	M20x1.5 M24x1.5 M25x1.5 M27x2	20	TPE VMQ	SE Cal
½ NPT mod ¾ NPT mod	16	½ NPT mod ¾ NPT mod	16	½ NPT mod ¾ NPT mod	16	½ NPT mod ¾ NPT mod	16	½ NPT mod ¾ NPT mod	16	FKM	SPU
PD		PD		PD		PD		PD			

Type of protection		Permitted use	Certificate No.	Protection principle
IECEx marking	ATEX marking			
Ex db IIC Gb	1026  II2G Ex db IIC Gb	Zone 1, Zone 2 Zone 21, Zone 22	FTZU 21 ATEX 0016U IECEx FTZU 21.0002U	Contain the explosion and quench the flame
Ex tb IIIC Db	1026  II2D Ex tb IIIC Db			

ORDERING

XD-FI... - . - **.. / ..** - **.. / ..** - **.. / ..** - **.. / ..** - **.. / ..** - **.. / ..** - **..**

Type of instrument housing

Version of instrument housing
 = standard
H = high cover
win = cover with window
Lwin = low cover with window
Hwin = high cover with window

Material of seal
 3 = TPE rubber
 4 = VMQ rubber
 5 = FKM rubber

Symbol of conduit thread D₅ - D₄ - D₃ - D₂
 Standard: M2 = M20×1.5
 N2 = ½ NPTmod – modified +1/2 to +1 thread deeper
 N3 = ¾ NPTmod – modified +1/2 to +1 thread deeper
 On request: M24 = M24×1.5
 M25 = M25×1.5
 PD = plugged
Notice:
 Type: "size of thread / PD" if thread is plugged, e.g. **M2/PD**, etc.

Symbol of process thread D₁
 Standard: M25 = M25×1.5
 N3 = ¾ NPTmod – modified +1/2 to +1 thread deeper
 On request: M2 = M20×1.5
 M24 = M24×1.5
 M27 = M27×2
 N2 = ½ NPTmod – modified +1/2 to +1 thread deeper
 PD = plugged
Notice:
 Type: "size of thread / PD" if thread is plugged ex. **M2/PD**, etc.

Symbol of paint type
 SE – spray epoxy – standard; SPU – spray polyurethane (on se layer); C – creodur

Paint colour
 RAL 9006, RAL 5005, RAL 5015, RAL 7032, RAL 9002, RAL 9007, RAL 1007 RAL 1003, RAL 7035, RAL 9010
 al = alu natural colour (for C paint type only)

STANDARD PRODUCT:

XD-FI4-D₅-D₄-D₃-D₂-D₁-SE RAL9006

Sample:

XD-FI4-M2-M2-M2-M2-M25-SE RAL9006

XD-FIwin-4-N3-N3-N3/PD-N3-N3-SE RAL9006

PROTECTION DEGREE	
IP	D ₅ , D ₄ , D ₃ , D ₂ , D ₁
54	threaded connection without additional sealing
68	threaded connection with additional sealing

XD-FI

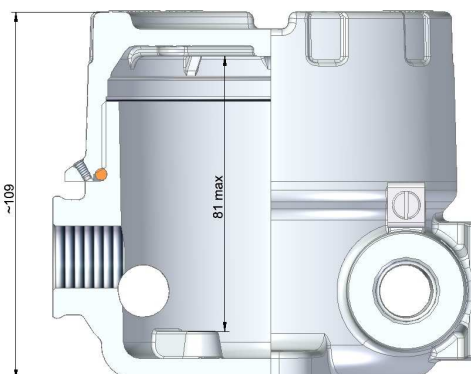

XD-FIwin

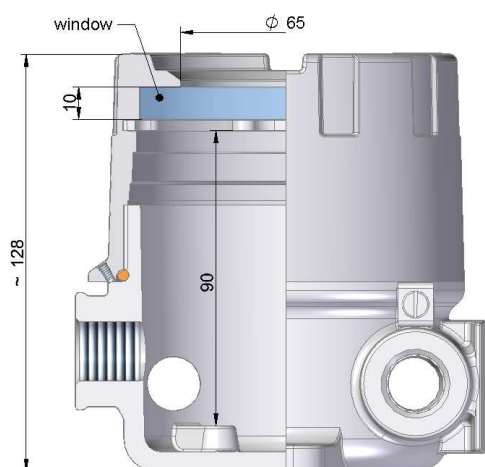

XD-FILwin

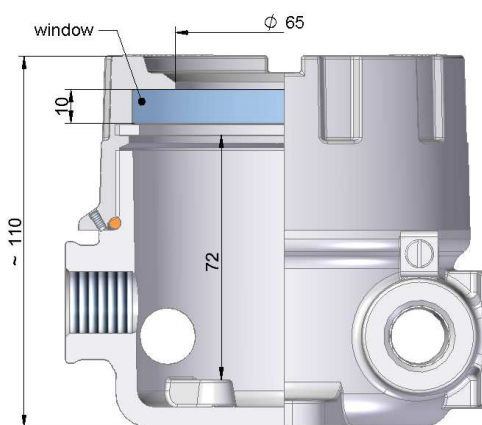

XD-FIH

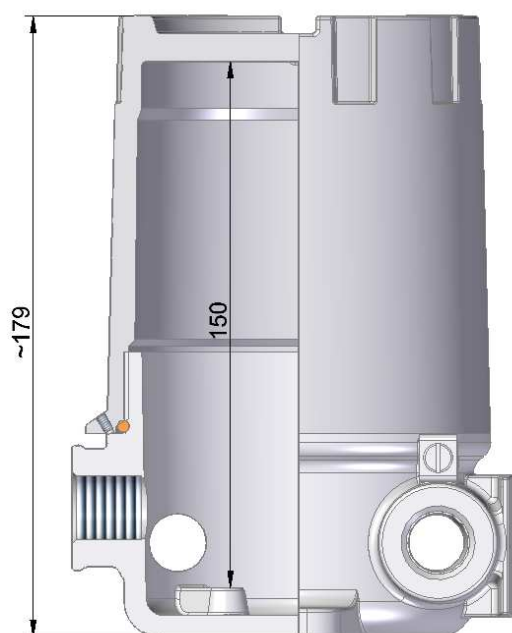

XD-FIHwin

