

TWO-COMPARTMENTS INSTRUMENT HOUSING – type XDE-D120

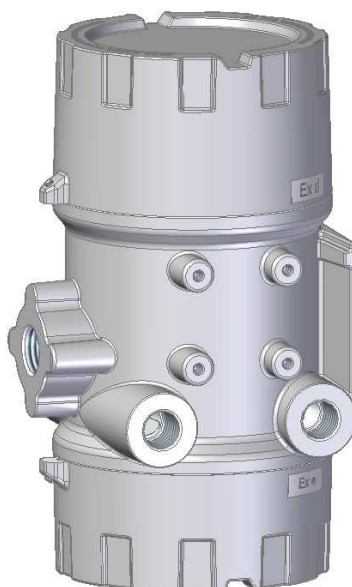
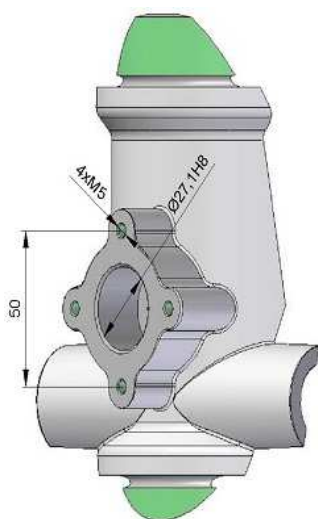
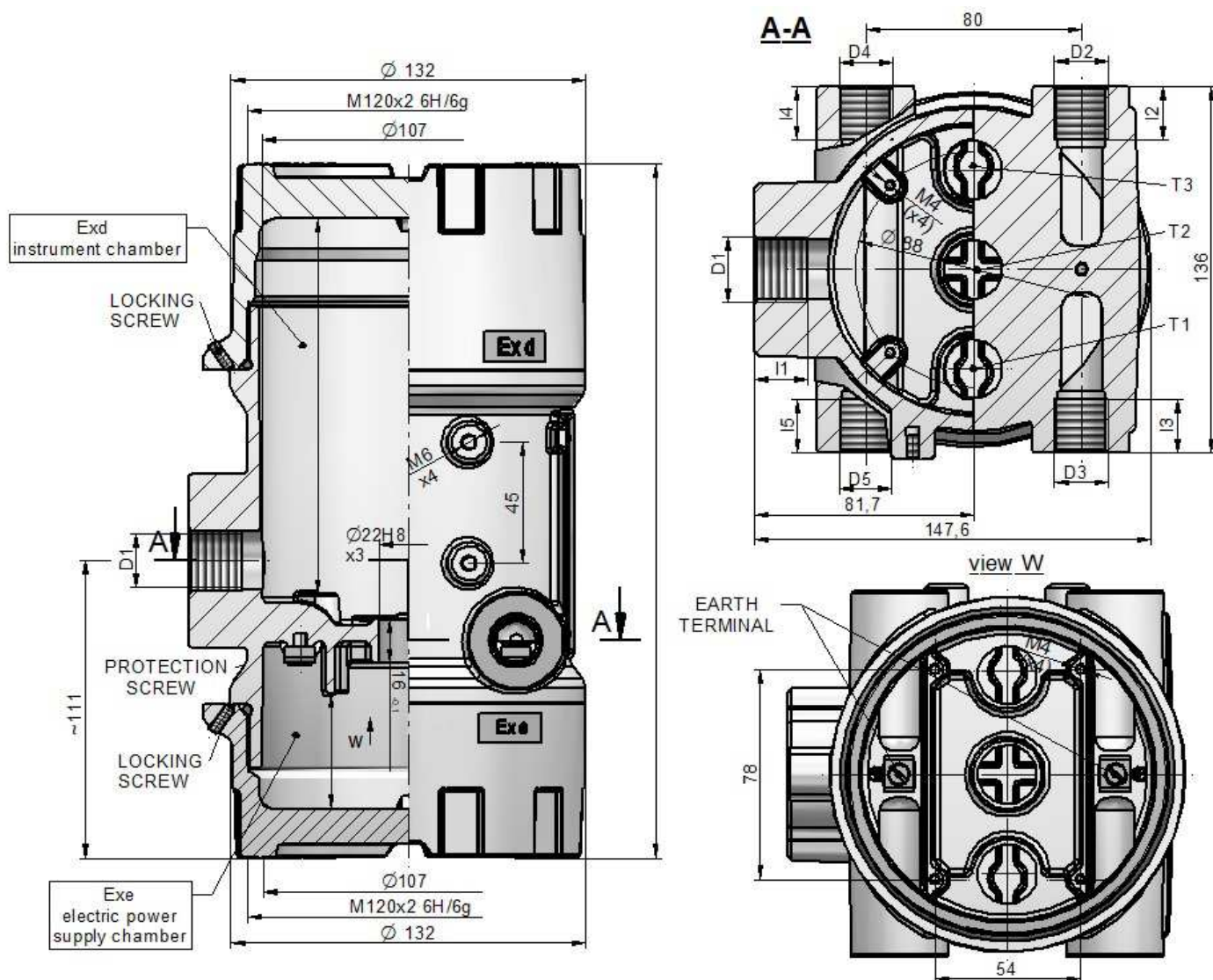

Material of body and cover: aluminium pressure die-casting**Service temperature:** $T_{serv} = -40 \div 150^{\circ}\text{C}$ (85°C with window) – silicone rubber**Coating:** yellow chromating and chemically resistant paint (outside only)

THREAD D ₃ , D ₅	l ₃ , l ₅ [mm]	THREAD D ₂ , D ₄	l ₂ , l ₄ [mm]	THREAD D ₁	l ₁ [mm]	4 × M5	SEAL MATERIAL	T ₁ , T ₂ , T ₃	COATING
M20×1.5 M24×1.5 M25×1.5	20	M20×1.5 M24×1.5 M25×1.5	20	Ø27,1 H8 M20×1.5 M24×1.5 M25×1.5 M27×2	20	option	VMQ	Ø22 H8	SE
½ NPT mod ¾ NPT mod	19	½ NPT mod ¾ NPT mod	19	½ NPT mod ¾ NPT mod 1 NPT mod	19				SPU Cal
PD		PD		PD				PD	

Type of protection ATEX Marking	Type of protection IECEx Marking	Permitted use	Certificate No.	Protection Principle
1026 II2G Ex db eb IIC Gb	Ex db eb IIC Gb	Zone 1, Zone 2	FTZU 08 ATEX 0182U	Contain the explosion and quench the flame
1026 II2D Ex tb IIIC Db	Ex tb IIIC Db	Zone 21, Zone 22	IECEx FTZU 09.0031U	

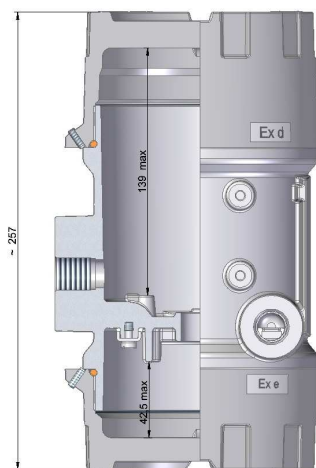
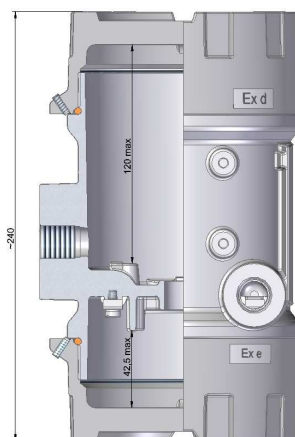
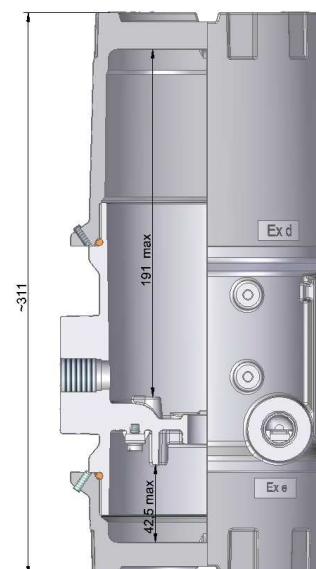
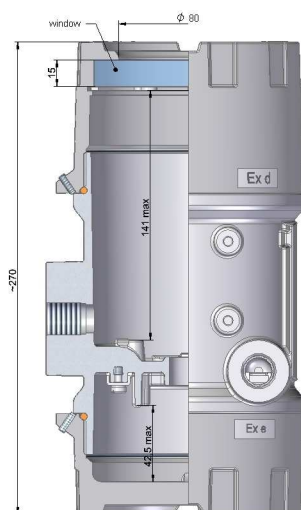
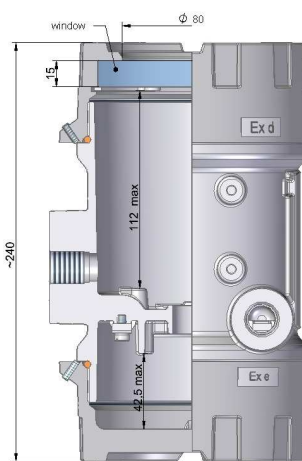
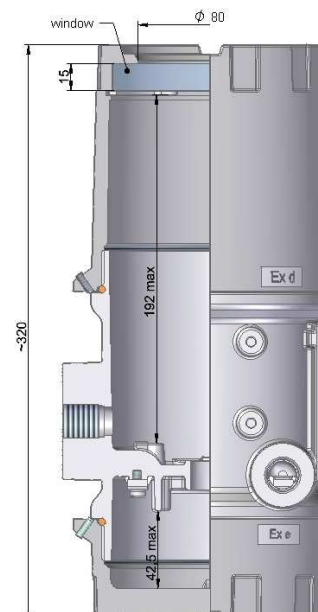
**XDE-D120****XDE-D120L****XDE-D120H****XDE-D120win****XDE-D120Lwin****XDE-D120Hwin**

ORDERING

XDE-D120... - . - **.. / ..** - **.. / ..** - **.. / ..** - **.. / ..** - **.. / ..** - **.. / ..** - **.. / .. / ..** - **. ..**

Type of instrument housing**Version of instrument housing**

= standard
L = low cover
H = high cover
win = cover with window
Lwin = low cover with window
Hwin = high cover with window

Material of seal

4 = VMQ rubber

Symbol of conduit thread D₅ - D₄ - D₃ - D₂**Standard:**

M2 = M20x1.5

On request:

M24 = M24x1.5

M25 = M25x1.5

N2 = ½ NPTmod – modified +1/2 to +1 thread deeper

N3 = ¾ NPTmod – modified +1/2 to +1 thread deeper

PD = plugged

Notice:

Type: "size of thread / PD" if thread is plugged, e.g. **M2/PD**, etc.

Symbol of process thread D₁**Standard:**

M24 = M24x1.5

On request:

Ø27,1 H8

M2 = M20x1.5

M25 = M25x1.5

M27 = M27x2

N2 = ½ NPTmod – modified +1/2 to +1 thread deeper

N3 = ¾ NPTmod – modified +1/2 to +1 thread deeper

PD = plugged

Notice:

Type: "size of thread / PD" if thread is plugged, e.g. **M2/PD**, etc.

Symbol of line bushing:

T1, T2, T3 = Ø22 H8

PD = plugged

Symbol of paint type

SE – spray epoxy – standard; SPU – spray polyurethane (on se layer); C – creodur

Paint colour

RAL 9006, RAL 5005, RAL 5015, RAL 7032, RAL 9002, RAL 9007, RAL 1007 RAL 1003, RAL 7035, RAL 9010

al = alu natural colour (for C paint type only)

PROTECTION DEGREE

IP	D ₅ , D ₄ , D ₃ , D ₂ , D ₁
54	threaded connections without additional sealing
68	threaded connections with additional sealing

STANDARD PRODUCTS:

XDE-D120-4-D₅-D₄-D₃-D₂-D₁-T1/T2/T3-SEsh

Sample:

XDE-D120-4-M2-M2-M2-M2-M24-T1/T2/T3-SE RAL9006

XDE-D120win-4-M2/PD-M2/PD-M2-M2-M24-PD/T2/PD-SE RAL9006