

INSTRUMENT HOUSING – type XD-I80

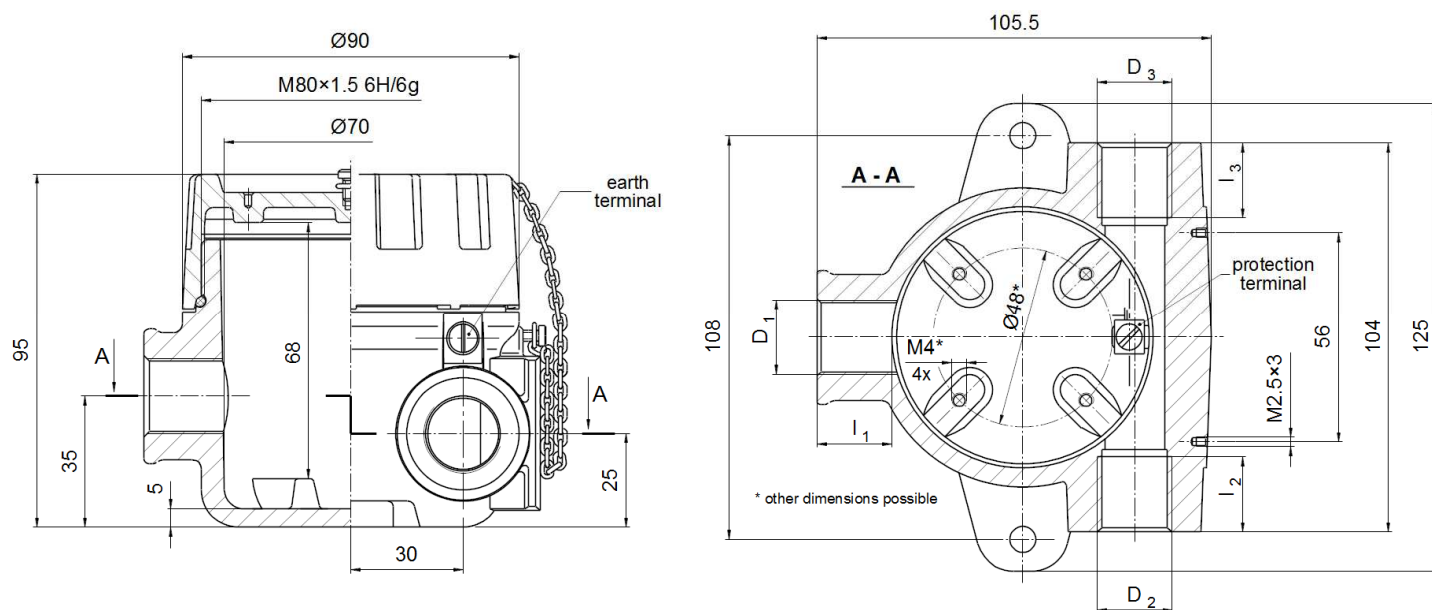

XD-I80



XD-I80C



Material of body and cover: aluminium pressure die-casting

Service temperature: $T_{serv} = -40 \div 212^{\circ}\text{F} / -40 \div 100^{\circ}\text{C}$ (185°F / 85°C with window) – silicone VMQ rubber

Coating: yellow chromating and chemically resistant paint (outside only)

THREAD D_3	I_3 [mm]	THREAD D_2	I_2 [mm]	THREAD D_1	I_1 [mm]	SEAL MATERIAL	COATING
M20x1.5 M24x1.5 M25x1.5	20	M20x1.5 M24x1.5 M25x1.5	20	M20x1.5 M24x1.5 M25x1.5 M27x2	20	4	SE
½ NPT mod ¾ NPT mod	16	½ NPT mod ¾ NPT mod	16	½ NPT mod ¾ NPT mod	16		Cal
PD		PD		PD			SPU
							PPU
							P

PROTECTION CONCEPT

Protection method	Type of protection	Marking	Permitted use	Approval Body	Certificate No.	Protection Principle
FM 3615	Explosionproof	Class I, Groups A,B,C,D	Division 1 Division 2	FM Approvals	3023004	Contain the explosion and quench the flame
CSA C22.2 No.30 ⁽¹⁾		Class II, Groups E,F,G; Class III Enclosure type: 4x		CSA	1717515	
ANSI/ISA 60079-1	Flameproof	Class I, Zone 1, AEx db II C, IP66	Zone 1 Zone 2	FM Approvals	3023004	
CSA C22.2 60079-1		Ex db II C, Class I, Zone 1, IP66		CSA	1717515	

⁽¹⁾ NPT threads only for CSA Division in all openings

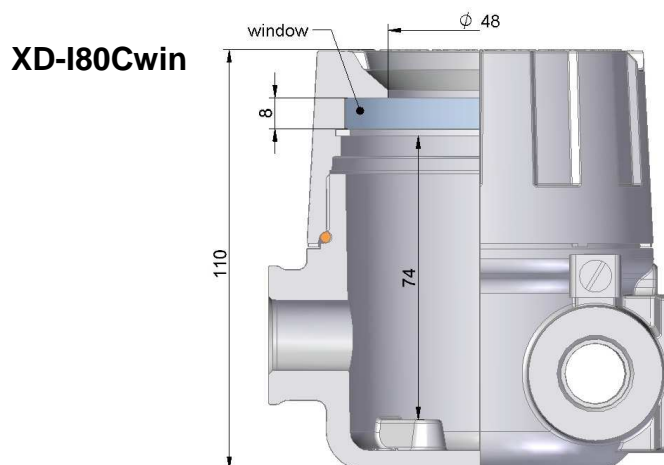
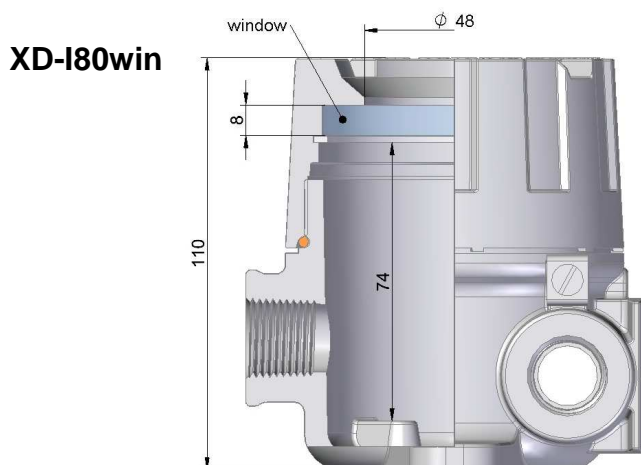

ORDERING

XD-I80... - . - **.. / ..** - **.. / ..** - **.. / ..** - **.. ..**

Type of instrument housing

Version of instrument housing

= standard
win = cover with window
C = without lugs
Cwin = without lugs, cover with window

Material of seal

4 = VMQ rubber

Symbol of conduit thread $D_3 - D_2$

Standard: M2 = M20×1.5
 N2 = ½ NPTmod – modified +1/2 to +1 thread depper
 N3 = ¾ NPTmod – modified +1/2 to +1 thread depper
 On request: M24 = M24×1.5
 M25 = M25×1.5
 PD = plugged

Notice:

Type: "size of thread / PD" if thread is plugged, e.g. **M2/PD**, etc.

Symbol of process thread D_1

Standard: M25 = M25×1.5
 N2 = ½ NPTmod – modified +1/2 to +1 thread depper
 N3 = ¾ NPTmod – modified +1/2 to +1 thread depper
 On request: M2 = M20×1.5
 M24 = M24×1.5
 M27 = M27×2
 PD = plugged

Notice:

Type: "size of thread / PD" if thread is plugged e.g. **M2/PD**, etc.

Symbol of paint type

SE – spray epoxy – standard; SPU – spray polyurethane (on se layer); C – creodur; PPU – polyurethane powder; P – polyester powder

Symbol of paint colour

sh = RAL 9006 shine – standard; **yc** = RAL 1007 yellow chromic; **ys** = RAL 1003 yellow signaling; **bs** = RAL 5005 blue signaling;
sb = RAL 5015 sky-blue; **sg** = RAL 7032 silicon-grey; **gr** = RAL 7035 grey; **ag** = RAL 9002 ashen grey-white; **gs** = RAL 9007 grey-silver;
cw = RAL 9010 cream-white; **al** = alu natural colour (for C paint type only)

STANDARD PRODUCTS:

XD-I804-D₃-D₂-D₁-SEsh

Sample:

XD-I804-M2-M2-M25-SEsh

XD-I80win-4-N3/PD-N3-N3-SEsh

PROTECTION AGAINST WATER and DUST INGRESS (Enclosure Type NEMA 4X)		
	IP	D ₃ , D ₂ , D ₁
NO	54	threaded connection without additional sealing
YES	66	threaded connection with additional sealing