

## INSTRUMENT HOUSING – type XD-l80win

**Material of body and cover:** aluminium pressure die-casting, max.0,5% Mg

**Ambient temperature:**  $T_{amb} = -40$  to  $185^{\circ}\text{F}$  ( $-40$  to  $85^{\circ}\text{C}$ ) – silicone rubber

**Coating:** yellow chromating and chemically resistant paint (outside only)

**Enclosure classification:** Type 4X, IP66

**Maximum space for transmitter:** Ø60x65

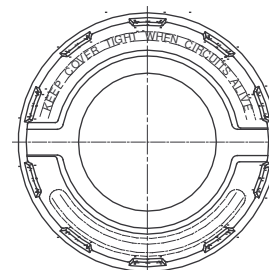
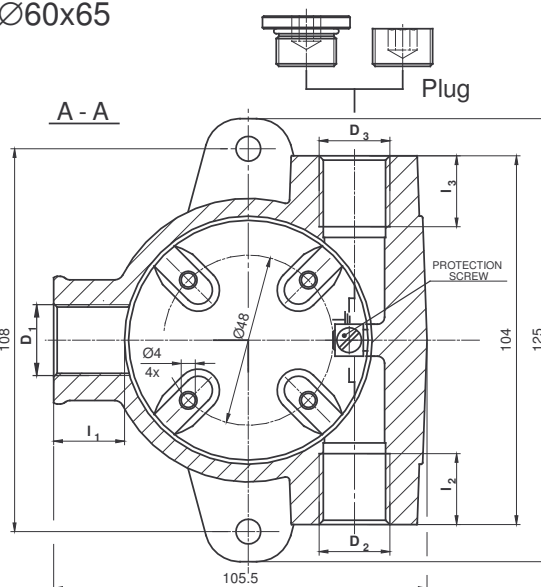
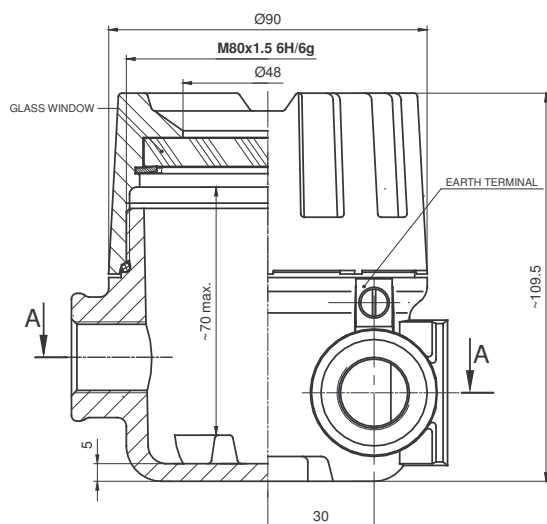

Cover – top view

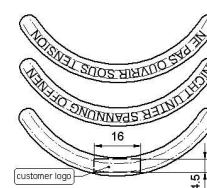

### Second caution inscription

STANDARD PRODUCT									
CONDUIT				PROCESS		SEAL MATERIAL	COATING**	Second caution inscription	ORDERING EXAMPLE
THREAD		THREAD		THREAD					
$D_3$	$I_2$ [mm]	$D_2$	$I_3$ [mm]	$D_1$	$I_1$ [mm]				
M20x1.5 6H	20	M20x1.5 6H	20	M20x1.5 6H M24x1,5 6H M25x1.5 6H M27x2 6H	20	S	SEsh	in French language	XD-I80win-2-M2-M2-M2-SEsh
				½ NPT mod* ¾ NPT mod*	~13 (7 full thds)				
OPTIONS ON REQUEST									
M24x1,5 6H M25x1.5 6H	20	M24x1,5 6H M25x1.5 6H	20	PD - plugged	X	X	SE..	Free language: German, Italian, Spanish, etc. or customer logo acc. To order	to fixing depend on chosen combination
½ NPT mod* ¾ NPT mod*	~13 (7 full thds)	½ NPT mod* ¾ NPT mod*	~13 (7 full thds)				Cal		
PD - plugged		PD - plugged					SPU..		

\* „mod” = thread modified acc. to FM 3615 and CSA C22.2 No. 30

body and cover

## PROTECTION CONCEPT

<i>Standard</i>	<i>Type of protection</i>	<i>Marking</i>	<i>Permitted use</i>	<i>Approval Body</i>	<i>Certificate No.</i>	<i>Protection Principle</i>
FM 3615	Explosionproof	Class I, Groups A,B,C,D Class II, Groups E,F,G; Class III Enclosure type: 4x	Division 1	FM Approvals	3019264	Contain the explosion and quench the flame
CSA C22.2 No.30 <sup>(1)</sup>			Division 2	CSA	1717515	
ANSI/ISA 12.22.01	Flameproof	Class I, Zone 1 AEx d II C, IP66	Zone 1	FM Approvals	3023004	
CSA E60079-1		Ex d II C, Class I, Zone 1, IP66		CSA	1717515	

<sup>(1)</sup> – for CSA Division, in all openings, NPT threads only

## ORDERING

<b>XD – I80win-</b>	-	<div style="border: 1px solid black; padding: 2px; display: inline-block;">             .. / ..           </div>	-	<div style="border: 1px solid black; padding: 2px; display: inline-block;">             .. / ..           </div>	-	<div style="border: 1px solid black; padding: 2px; display: inline-block;">             .. / ..           </div>	-	<div style="border: 1px solid black; padding: 2px; display: inline-block;">             . .           </div>
<div style="display: flex; justify-content: space-between;"> <div style="width: 20%;">           TYPE OF INSTRUMENT HOUSING         </div> <div style="width: 20%;">           SYMBOL OF ELEMENTS / SEALS MATERIAL            2 = M+S            4 = N+S         </div> <div style="width: 60%;"></div> </div>								
SYMBOL OF CONDUIT THREAD $D_3 - D_2$ M2 = M20x1,5 6H M24 = M24x1.5 6H M25 = M25x1.5 6H N2 = 1/2 NPTmod – modified ac. to FM3615 and CSA C22.2 No. 0.5 N3 = 3/4 NPTmod – modified ac. to FM3615 and CSA C22.2 No. 0.5 PD = plugged  <b>Notice:</b> Type: "size of thread / PD" if thread is plugged ex. <b>M2/PD</b> ,etc.								
SYMBOL OF PROCESS THREAD $D_1$ M2 = M20x1,5 6H M24 = M24x1.5 6H M25 = M25x1.5 6H M27 = M27x2 6H N2 = 1/2 NPTmod – modified ac. to FM3615 and CSA C22.2 No. 0.5 N3 = 3/4 NPTmod – modified ac. to FM3615 and CSA C22.2 No. 0.5 PD = plugged  <b>Notice:</b> Type: "size of thread / PD" if thread is plugged ex. <b>M2/PD</b> ,etc.								
SYMBOL OF PAINT TYPE: C – CREODUR, SE – SPRAY EPOXY; SPU – SPRAY POLIURETHANE (on SE layer)								
SYMBOL OF PAINT COLOUR : al = alu natural colour; yc = RAL 1007 – yellow–chromic; ys = RAL 1003 – yellow–signalling; bs = RAL 5005 blue signalling; sb = RAL 5015 sky-blue; sg = RAL 7032 silicon–grey; gr = RAL 7035 grey; ag = RAL 9002 ashen grey-white; sh =RAL 9006 shine; gs = RAL 9007 grey–silver; cw = RAL 9010 cream-white (for more details see technical information)								

### SAMPLE:

**STANDARD: XD-I80win-2-M2-M2-M25-SEsh**  
**ON REQUEST:**

- 1.) XD-I80win-2-N3/PD-M2/PD-M25/PD-SEsb
- 2.) XD-I80w-4-N2-N2/PD-N3-SEsb

PROTECTION AGAINST WATER AND DUST INGRESS (Enclosure type NEMA 4x)			
	D <sub>3</sub>	D <sub>2</sub>	D <sub>1</sub>
NO	1.Parallel and taper thread are manufactured in the standard accuracy class of manufacturing. 2.No gasket, no packing with any packing agent.		
YES	Threads are additionally packed with use of – for example – LOCTITE 577 agent.		
For more details see technical information			